



ANS
UPVC SOLUTIONS

UPVC Door & Window Hardware



About Us



At ANS Solution we aim to provide every uPVC fabricator with everything they need. ANS Solution is your one-stop solution for all your uPVC needs. We provide wide ranges of handles, hinges, rollers, espases, friction stays, and EPDM rubber gaskets.

SLIDING SERIES

The uPVC Sliding series hardware plays a vital role in creating a seamless experience for you and for the aura of your home. We at ANS focus on bringing splendid handles rollers and other sliding accessories to facilitate your home with modern design.



Rollers

SINGLE GROOVE ROLLER

FEATURES

- CAPACITY 40KG
- FITS ALL EURO AND NON EURO GROOVE PROFILES
- MATERIAL ZINC/NICKEL/CHROME/STAINLESS STEEL
- DIMENSIONS 16X14MM(WXL)
- HIGH-QUALITY NEEDLE BEARING
- NOISELESS OPERATION

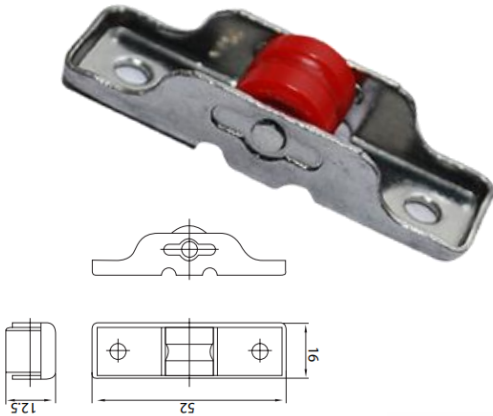

SINGLE FLAT ROLLER

FEATURES

- CAPACITY 40KG
- FITS ALL EURO AND NON EURO GROOVE PROFILES
- MATERIAL ZINC/NICKEL/CHROME/STAINLESS STEEL
- DIMENSIONS 16X14MM(WXL)
- HIGH QUALITY BEARING
- NOISELESS OPERATION

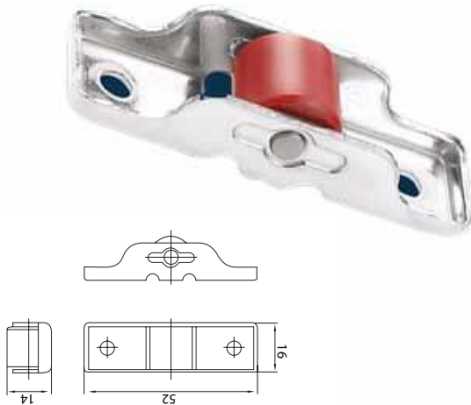

DOUBLE GROOVE ROLLER

FEATURES

- CAPACITY 60KG.
- FITS ALL EURO AND NON EURO GROOVE PROFILES.
- MATERIAL ZINC/NICKEL/CHROME/STAINLESS STEEL.
- DIMENSIONS 16X14MM(WXL).
- HIGH QUALITY NEEDLE BEARING.
- NOISELESS OPERATION.

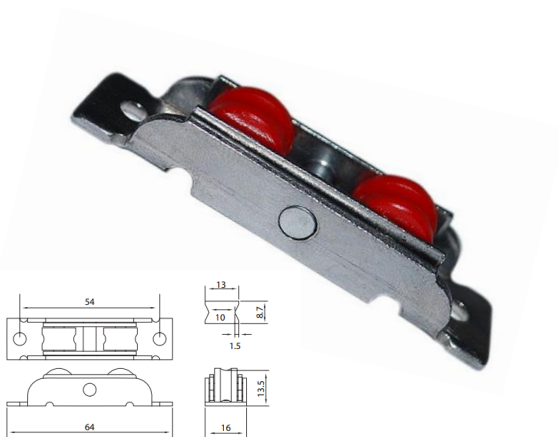

Rollers



ADJUSTABLE ROLLER NYLON

FEATURES

- CAPACITY 90KG FOR TWO ROLLERS.
- COMPATIBLE WITH ALL STANDARD PROFILES.
- MATERIAL NYLON.
- DIMENSIONS 12X20X160MM (WDXL).
- ADJUSTABLE TO 21 TO 27MM.

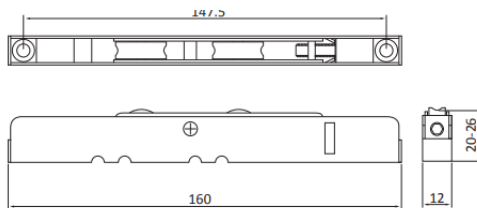

ADJUSTABLE ROLLER STEEL

FEATURES

- CAPACITY 120KG FOR TWO ROLLERS.
- COMPATIBLE WITH ALL STANDARD PROFILES.
- MATERIAL GALVANIZED STEEL
- DIMENSIONS 12X20X160MM (WDXL).
- ADJUSTABLE TO 21 TO 27MM.

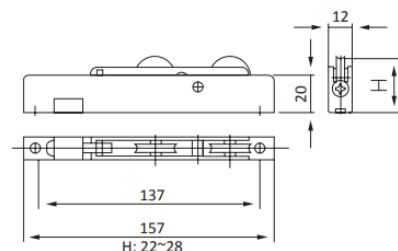

ADJUSTABLE ROLLER FOUR WHEEL

FEATURES

- CAPACITY 250KG FOR FOUR ROLLERS.
- COMPATIBLE WITH ALL STANDARD PROFILES.
- MATERIAL GALVANIZED STEEL
- ADJUSTABLE TO 21 TO 27MM.

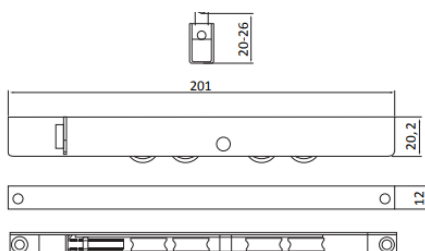

Rollers

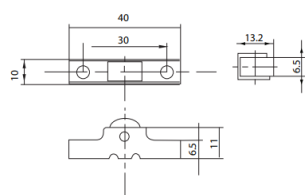

MESH ROLLER

FEATURES

- 10MM STEEL MESH ROLLER
- LOAD CAPACITY 20KG/PAIR
- FRAME MATERIAL SS304
- ROLLER MATERIAL NYLON

MESH ROLLER

FEATURES

- 10MM BUG MESH ROLLER
- LOAD CAPACITY 15KG/PAIR
- FRAME MATERIAL NYLON
- WHEEL MATERIAL BRASS

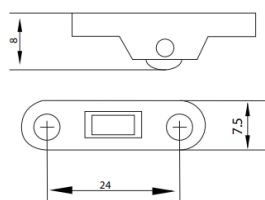

Handles

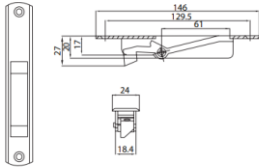

TOUCH LOCK PLAIN

FEATURES

- SINGLE POINT FLUSH TYPE SLIDING HANDLE.
- EASY TO OPERATE
- AVAILABLE IN LEFT AND RIGHT OPTION.
- MADE OUT OF ALUMINIUM DIECASTING AND ZINC DIECASTING

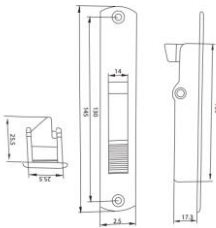

TOUCH LOCK LINE

FEATURES

- SINGLE POINT FLUSH TYPE SLIDING HANDLE.
- EASY TO OPERATE
- AVAILABLE IN LEFT AND RIGHT OPTION.
- MADE OUT OF ALUMINIUM DIECASTING AND ZINC DIECASTING



TOUCH LOCK LG TYPE

FEATURES

- SINGLE POINT FLUSH TYPE SLIDING HANDLE.
- EASY TO OPERATE
- AVAILABLE WITH CHROME STRIKER

Handles

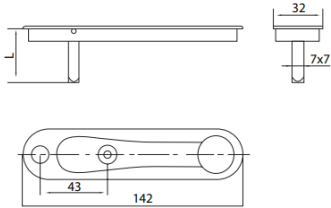

POP UP HANDLE

FEATURES

- SLIDING FLUSH TYPE HANDLE.
- HANDLE AND ESPAG COMPATIBILITY IS EVIDENT.
- MULTI POINT LOCKING.
- ENHANCED SECURITY .
- MATERIAL ZINC ALLOY/ ALUMINIUM

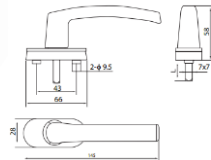

SLIDING HANDLE W/O KEY

FEATURES

- SINGLE POINT TYPE SLIDING HANDLE.
- EASY TO OPERATE
- MADE OUT OF ALUMINIUM DIECASTING AND PLASTIC

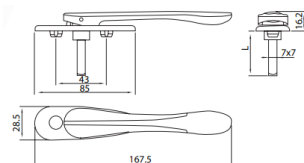

SHORT NECK HANDLE LONG SPINDLE

FEATURES

- COMPATIBLE WITH WIDE RANGE OF PROFILES.
- DESIGNED FOR DOORS AND DOORS WITH MESH
- KEY MATERIAL: ALUMINIUM
- ENHANCED SECURITY | MULTI POINT LOCKING

Handles

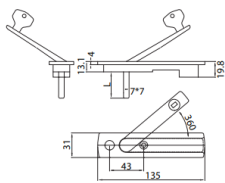

POP UP HANDLE WITH KEY

FEATURES

- SLIDING FLUSH TYPE HANDLE.
- HANDLE AND ESPAG COMPATIBILITY IS EVIDENT.
- MULTI POINT LOCKING.
- ENHANCED SECURITY | MULTI POINT LOCKING
- MATERIAL ZINC ALLOY/ ALUMINIUM

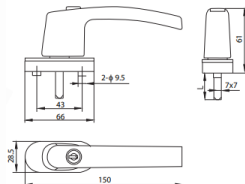

SLIDING HANDLE WITH KEY

FEATURES

- SLIDING ESPAGE HANDLE WITH KEY OPTIONS.
- HEAVY DUTY HANDLE.
- HANDLE AND ESPAGNOLLETE COMPATIBILITY IS EVIDENT
- KEY MATERIAL: ALUMINIUM AND ZINC
- ENHANCED SECURITY | MULTI POINT LOCKING
- METAL SCREW CAP

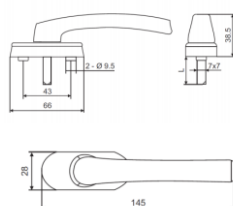

SHORT NECK HANDLE LONG SPINDLE

FEATURES

- COMPATIBLE WITH WIDE RANGE OF PROFILES.
- DESIGNED FOR DOORS AND DOORS WITH MESH
- KEY MATERIAL: ALUMINIUM
- ENHANCED SECURITY | MULTI POINT LOCKING

Handles

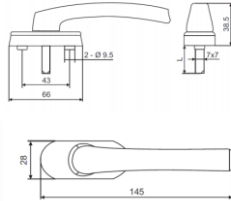

SHORT NECK HANDLE

FEATURES

- COMPATIBLE WITH WIDE RANGE OF PROFILES.
- DESIGNED FOR DOORS AND DOORS WITH MESH
- KEY MATERIAL: ALUMINIUM
- ENHANCED SECURITY | MULTI POINT LOCKING

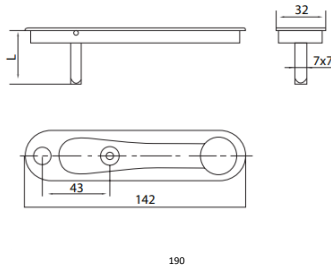

BIG POP UP HANDLE

FEATURES

- COMPATIBLE WITH WIDE RANGE OF PROFILES.
- DESIGNED FOR DOORS AND DOORS WITH MESH
- KEY MATERIAL: ALUMINIUM
- LONG SPINDLE
- ENHANCED SECURITY | MULTI POINT LOCKING

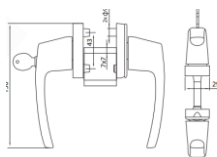

BOTH SIDE HANDLE OSK

FEATURES

- COMPATIBLE WITH WIDE RANGE OF PROFILES.
- DESIGNED FOR DOORS AND DOORS WITH MESH
- KEY MATERIAL: ALUMINIUM
- LONG SPINDLE
- ENHANCED SECURITY | MULTI POINT LOCKING

Handle Set

SLIDING D HANDLE SETS

FEATURES

- COMPATIBLE WITH WIDE RANGE OF PROFILES
- COMES WITH 1800MM LOCKABLE ESPAG
- 62MM BSK/OSK CYLINDER
- ALSO AVAILABLE AS DUMMY HANDLE WITHOUT LOCKING

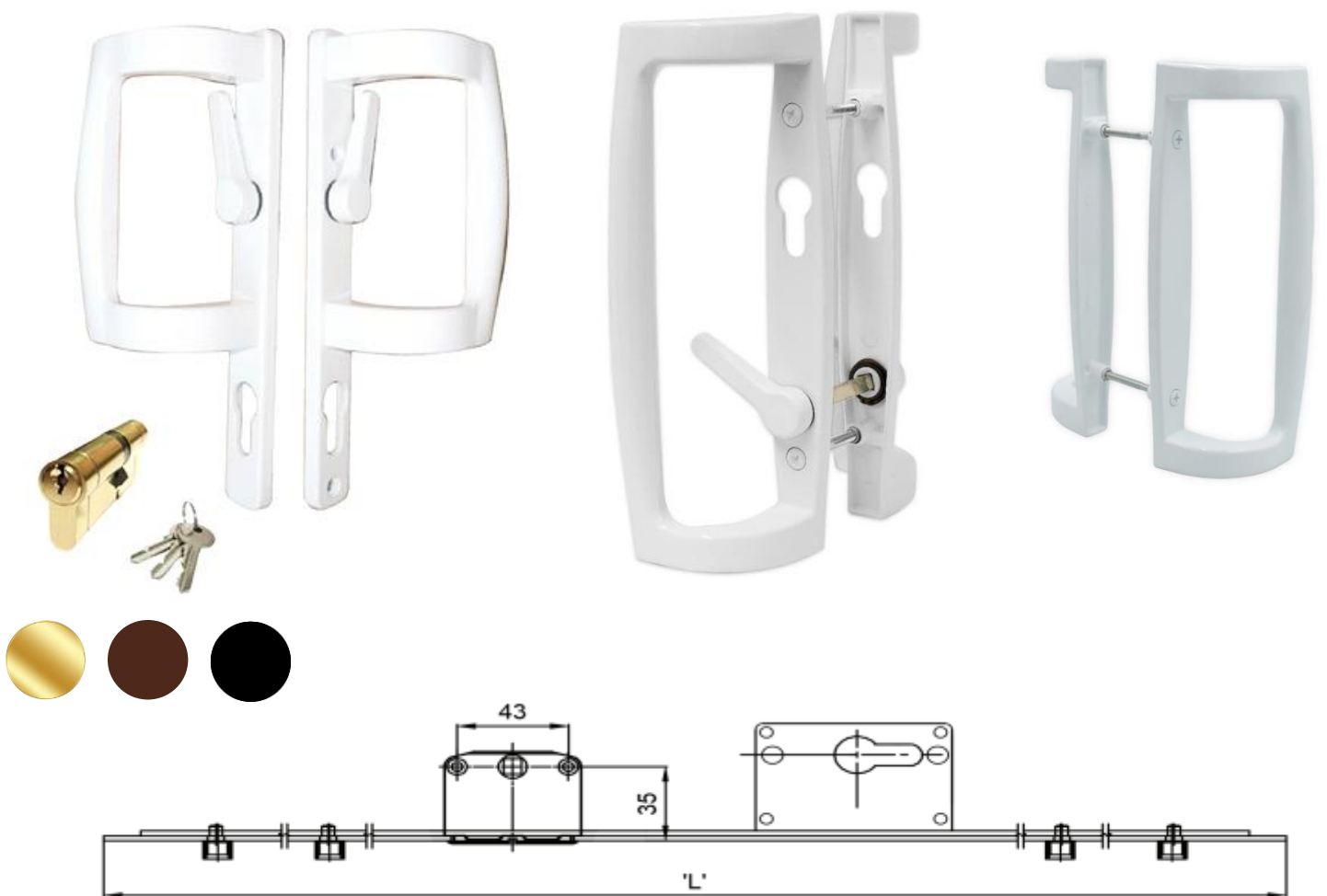



SLIDING WINDOW ESPAGE

FEATURES

- COMPATIBLE WITH WIDE RANGE OF PROFILES
- BACKSET 7.5MM WITH LENGTH 800-2000MM
- WORKS IMPRESSIVELY UNDER HEAVY GASKET PRESSURE
- MULTI POINT LOCKING SYSTEM
- ENHANCED SECURITY WEATHER SEALING AND NOISE SEALING
- ZINC PLATING

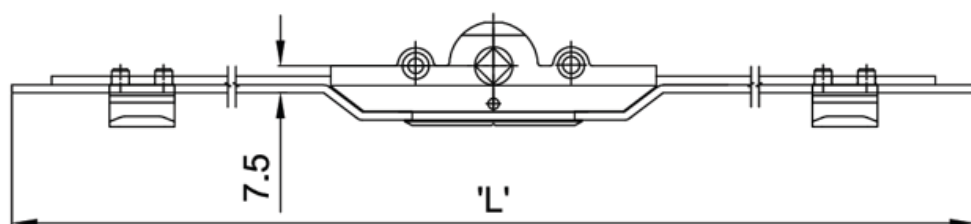

SUITABLE FOR	LOCKING POINT TYPE	'L' LENGTH OF ESPAGE	BACKSET(MM)	NO. OF LOCKING POINTS
SLIDING WINDOW	ZAMAC	800	7.5	2
SLIDING WINDOW	ZAMAC	1000	7.5	2
SLIDING WINDOW	ZAMAC	1200	7.5	2
SLIDING WINDOW	ZAMAC	1600	7.5	4
SLIDING WINDOW	ZAMAC	1800	7.5	4
SLIDING WINDOW	ZAMAC	2000	7.5	4



SLIDING DOOR ESPAGE

FEATURES

- COMPATIBLE WITH WIDE RANGE OF PROFILES
- BACKSET 15MM WITH LENGTH 800-2000MM
- WORKS IMPRESSIVELY UNDER HEAVY GASKET PRESSURE
- MULTI POINT LOCKING SYSTEM
- ENHANCED SECURITY WEATHER SEALING AND NOISE SEALING
- ZINC PLATING

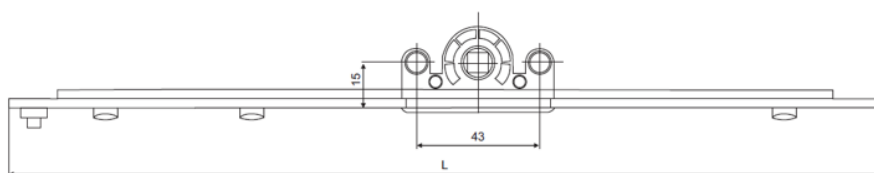

SUITABLE FOR	LOCKING POINT TYPE	'L' LENGTH OF ESPAGE	BACKSET(MM)	NO. OF LOCKING POINTS
SLIDING DOOR	ZAMAC	800	15	2
SLIDING DOOR	ZAMAC	1000	15	2
SLIDING DOOR	ZAMAC	1200	15	2
SLIDING DOOR	ZAMAC	1600	15	4
SLIDING DOOR	ZAMAC	1800	15	4
SLIDING DOOR	ZAMAC	2000	15	4

CASEMENT SERIES

The casement series hardware brings out the soul of your casement doors and windows by facilitating free and smooth movements for ages to come. Our casement doors and window handles are designed to create an aura for your home. Hinges and Stays ensure that your movement is not restricted throughout



HANDLES

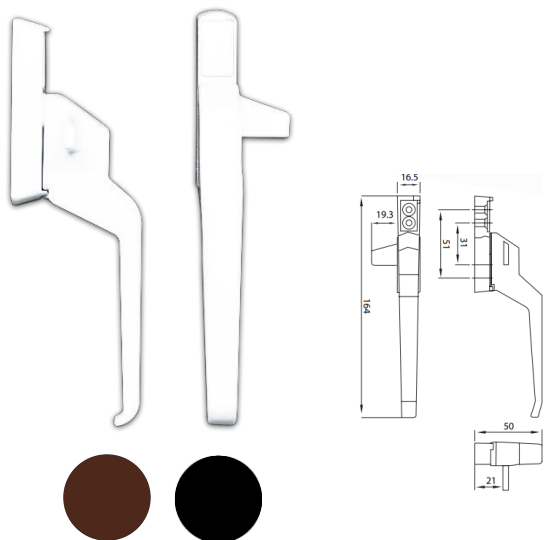

COCKSPUR HANDLE

FEATURES

- COMPATIBLE WITH ALL PROFILES.
- SLOT FREE INSTALLATION.
- FACE FIXED EASY INSTALLATION
- AVAILABLE IN LEFT AND RIGHT OPTIONS
- SUPPLIED WITH PACKERS TO FIT ALL PROFILES



CASEMENT WINDOW HANDLE

FEATURES

- COMPATIBLE WITH ALL PROFILES.
- HEAVY DUTY HANDLE.
- HANDLE AND ESPAGNOLLETE COMPATIBILITY IS EVIDENT
- KEY MATERIAL: ALUMINIUM

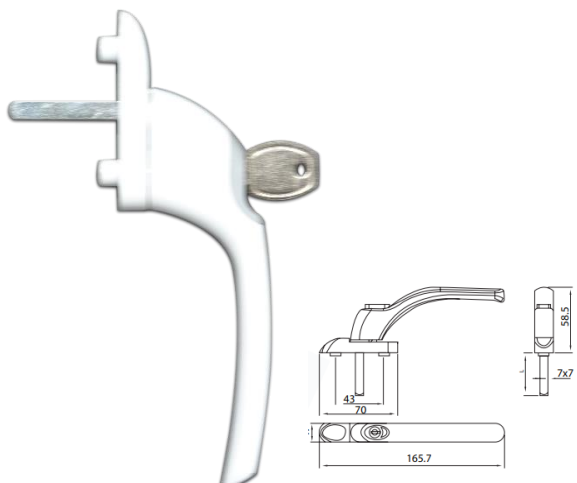

CASEMENT WINDOW HANDLE WITH KEY

FEATURES

- COMPATIBLE WITH WIDE RANGE OF PROFILES.
- 35MM LONG SPINDLE.
- WITH KEY
- HANDLE AND ESPAGNOLLETE COMPATIBILITY IS EVIDENT

HANDLES

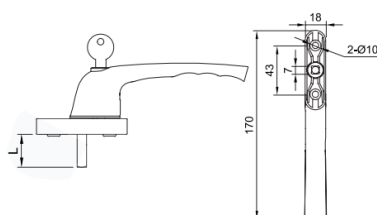

CASEMENT WINDOW HANDLE WITH KEY

FEATURES

COMPATIBLE WITH WIDE RANGE OF PROFILES.
35MM LONG SPINDLE.
WITH KEY AND BUTTON
HANDLE AND ESPAGNOLLETE COMPATIBILITY
IS EVIDENT

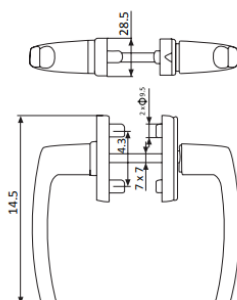

CASEMENT DOOR BOTH SIDE HANDLE

FEATURES

- ROBUST SPRING LOADED GEARING.
- 115MM LONG SPINDLE.
- MULTI PLACE LOCKING
- ENHANCED SECURITY BETTER WEATHER SEALING

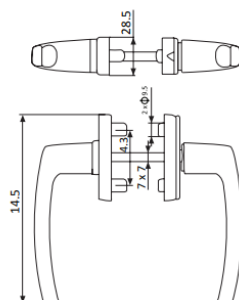

CASEMENT DOOR BOTH SIDE HANDLE

FEATURES

- ROBUST SPRING LOADED GEARING.
- 115MM LONG SPINDLE.
- ONE SIDE KEY IS AVAILABLE
- MULTI PLACE LOCKING
- ENHANCED SECURITY BETTER WEATHER SEALING



MORTISE LOCK SET FEATURES

- 85/35MM ESPAGE
- CASEMENT BOTH SIDE HANDLES
- CYLINDER
- CENTRE STRIKER

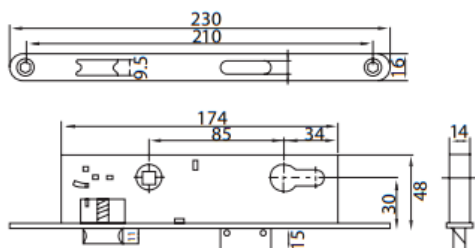

CASEMENT DOOR SET WITH ESPAGE

FEATURES

- 1800/35MM ESPAGE
- CASEMENT BOTH SIDE HANDLE
- CYLINDER
- CENTRE STRIKER

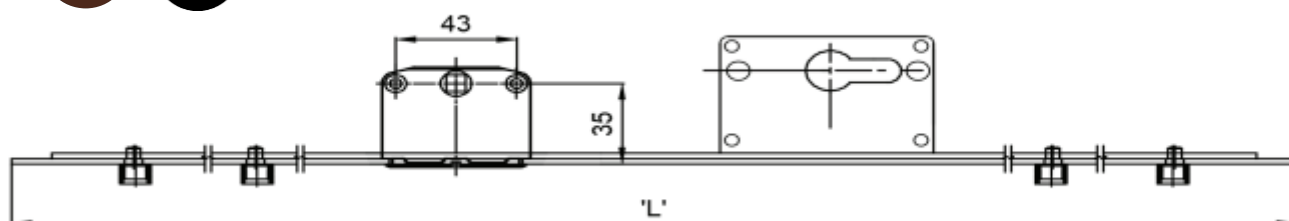



- CAN BE USED FOR UPTO 100KG SASH WEIGHT.
- SIDE HUNG WINDOW AND DOOR
- SUITABLE FOR OUTWARD OPENING DOOR
- CAN BE ADJUSTED IN THREE DIMENSIONS FOR BETTER ASSEMBLY FUNCTIONS



- CAN BE USED FOR UPTO 120KG SASH WEIGHT.
- SIDE HUNG WINDOW AND DOOR
- SUITABLE FOR OUTWARD OPENING DOOR
- CAN BE ADJUSTED IN THREE DIMENSIONS FOR BETTER ASSEMBLY FUNCTIONS



- CAN BE USED FOR UPTO 80KG SASH WEIGHT.
- SIDE HUNG WINDOW AND DOOR
- SUITABLE FOR OUTWARD OPENING DOOR
- UNIVERSAL PROFILE COMPATIBILITY

HINGES

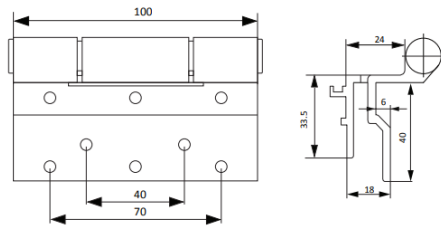
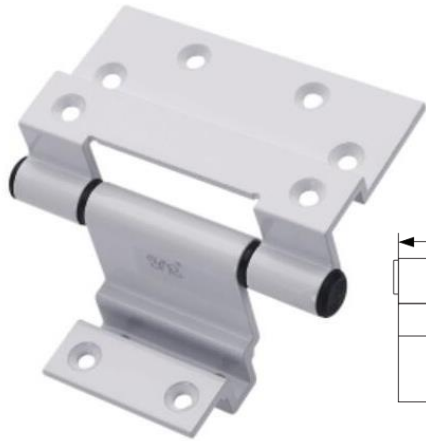

L HINGE

FEATURES

- CAN BE USED FOR UPTO 40KG SASH WEIGHT.
- SIDE HUNG WINDOW AND DOOR
- SUITABLE FOR OUTWARD OPENING DOOR

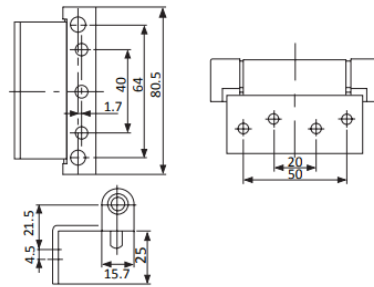

FLAT HINGE

FEATURES

- CAN BE USED FOR UPTO 40KG SASH WEIGHT.
- SIDE HUNG WINDOW AND DOOR
- SUITABLE FOR OUTWARD OPENING DOOR
- UNIVERSAL PROFILE COMPATIBILITY

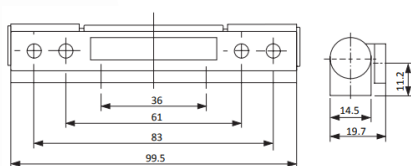

BUTT HINGE

FEATURES

- CAN BE USED FOR UPTO 40KG SASH WEIGHT.
- SIDE HUNG WINDOW AND DOOR
- SUITABLE FOR OUTWARD OPENING DOOR
- UNIVERSAL PROFILE COMPATIBILITY

FRICTION STAY



FRICTION STAY SS 304

FEATURES

- AVAILABLE IN HIGHER CORROSION RESISTANT.
- SS 304 AUTHENTIC STEEL
- APPLICATION HEAVY DUTY SIDE HUNG
- UNIVERSAL PROFILE COMPATIBILITY



FRICTION STAY SS 202

FEATURES

- AVAILABLE IN HIGHER CORROSION RESISTANT.
- SS 202 2.5MM / 2MM
- APPLICATION LIGHT DUTY SIDE HUNG
- UNIVERSAL PROFILE COMPATIBILITY

ESPAGES

CASEMENT ESPAGE 22MM BACKSET

FEATURES

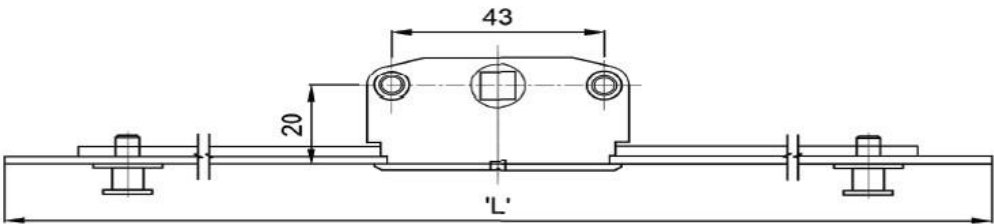

SUITABLE FOR	LOCKING POINT TYPE	'L' LENGTH OF ESPAGE	BACKSET(MM)	NO. OF LOCKING POINTS
CASEMENT WINDOW	ZAMAC	600	22	2
CASEMENT WINDOW	ZAMAC	800	22	2
CASEMENT WINDOW	ZAMAC	1000	22	2
CASEMENTWINDOW	ZAMAC	1200	22	2
CASEMENTWINDOW	ZAMAC	1600	22	4
CASEMENT WINDOW	ZAMAC	1800	22	4
CASEMENT WINDOW	ZAMAC	2000	22	4

ESPAGES

CASEMENT ESPAGE WITH CYLINDER 35MM BACKSET

FEATURES

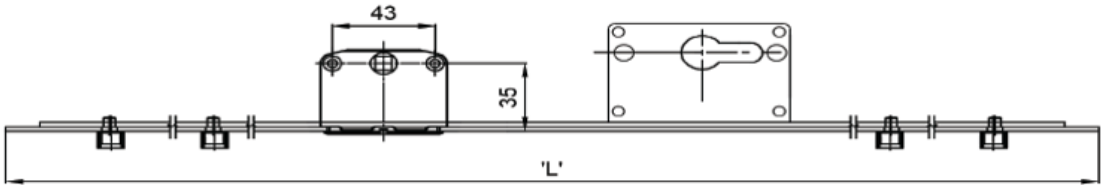

SUITABLE FOR	LOCKING POINT TYPE	'L' LENGTH OF ESPAGE	BACKSET(MM)	NO. OF LOCKING POINTS
CASEMENT WINDOW	ZAMAC	600	22	2
CASEMENT WINDOW	ZAMAC	800	22	2
CASEMENT WINDOW	ZAMAC	1000	22	2
CASEMENTWINDOW	ZAMAC	1200	22	2
CASEMENTWINDOW	ZAMAC	1600	22	4
CASEMENT WINDOW	ZAMAC	1800	22	4
CASEMENT WINDOW	ZAMAC	2000	22	4

ACCESSORIES



ACCESSORIES



FASTNERS

FEATURES

- UPVC FRAME FIXING ANCHORS
- AVAILABLE IN DIFFERENT SIZES
- MS AND SS BODY AVAILABLE WITH NYLON FRAME
- ZINC GALVANISED



SILICONIZED WOOLPILE

FEATURES

- SILICONIZED WOOLPILE
- AVAILABLE IN DIFFERENT SIZES
- 3P AND 4P AVAILABLE
- GREY AND BLACK AVAILABLE



SELF DRILLING SCREWS

FEATURES

- SS AND MS AVAILABLE
- ZINC COATED
- ALL SIZES AVAILABLE

PLASTIC ITEMS



FASTNER CAPS



DRAINAGE CAP



BUM STOPPER



ANTILIFT BLOCK



LIFTING WEDGE



GLASS PACKER



U PACKER



PVC LOUVERS

... MANY MORE

UPVC GASKETS

We are the industry leaders in EPDM rubber gasket manufacturing, as many of us are aware of the benefits of EPDM (Ethylene Propylene Diene Monomer), rubber profiles do not just hold the glass but also increase the longevity of Upvc doors and windows



UPVC GASKETS

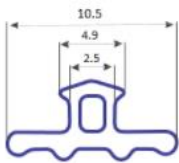

AP 01
1MM E TYPE

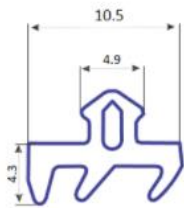

AP 03
3MM E TYPE

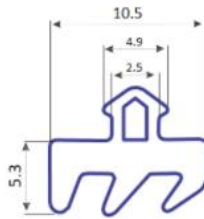

AP 04
4MM E TYPE

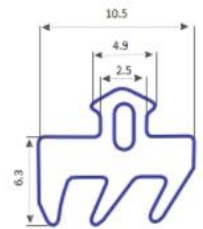

AP 05
5MM E TYPE

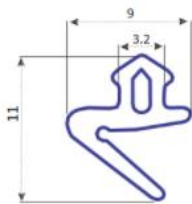

AP 06
SASH SEAL

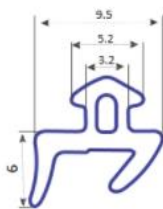

AP 07
K TYPE

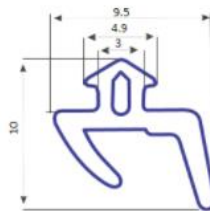

AP 08
K TYPE

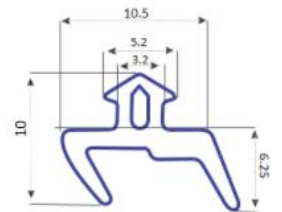

AP 09
K TYPE

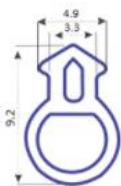

AP 10
O TYPE SMALL

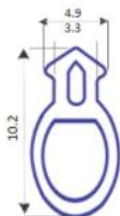

AP 11
OVAL O TYPE

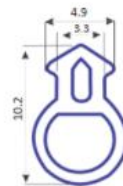

AP 12
O TYPE BIG

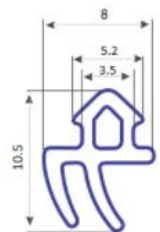

AP 13

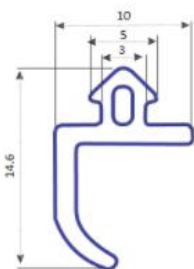

AP 14

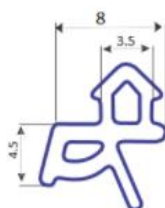

AP 15
R TYPE

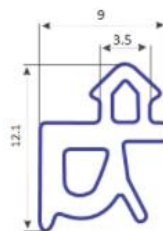

AP 16

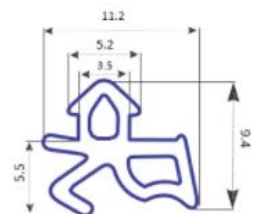

AP 17
R TYPE

UPVC GASKETS



AP 22

4.5MM MESH



AP 23

6.5MM MESH



AP 24

5.5 MESH



AP 25

5MM MESH



AP 26

5.5 MM MESH



AP 27

4.2MM MESH



AP 28

4.5MM MESH



AP 29

4 MM MESH



AP 30

5.2 MM MESH



AP 31

5.5MM MESH



AP 32

6.3 MM MESH



AP 33

6.5 MM MESH



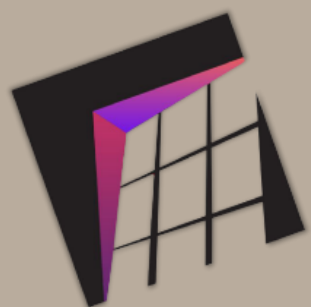

ANS
UPVC SOLUTIONS

UPVC Door & Window Hardware

®

ansupvc@gmail.com | +91 88260 87927 | www.ansupvc.com

ANS UPVC SOLUTIONS

Near Punjabi Dharamshala, Mohna Road Ballabhgarh, Faridabad